



CORYDON, IOWA

CIRCU-LATOR JR. PARTS MANUAL

5/90

P-10588

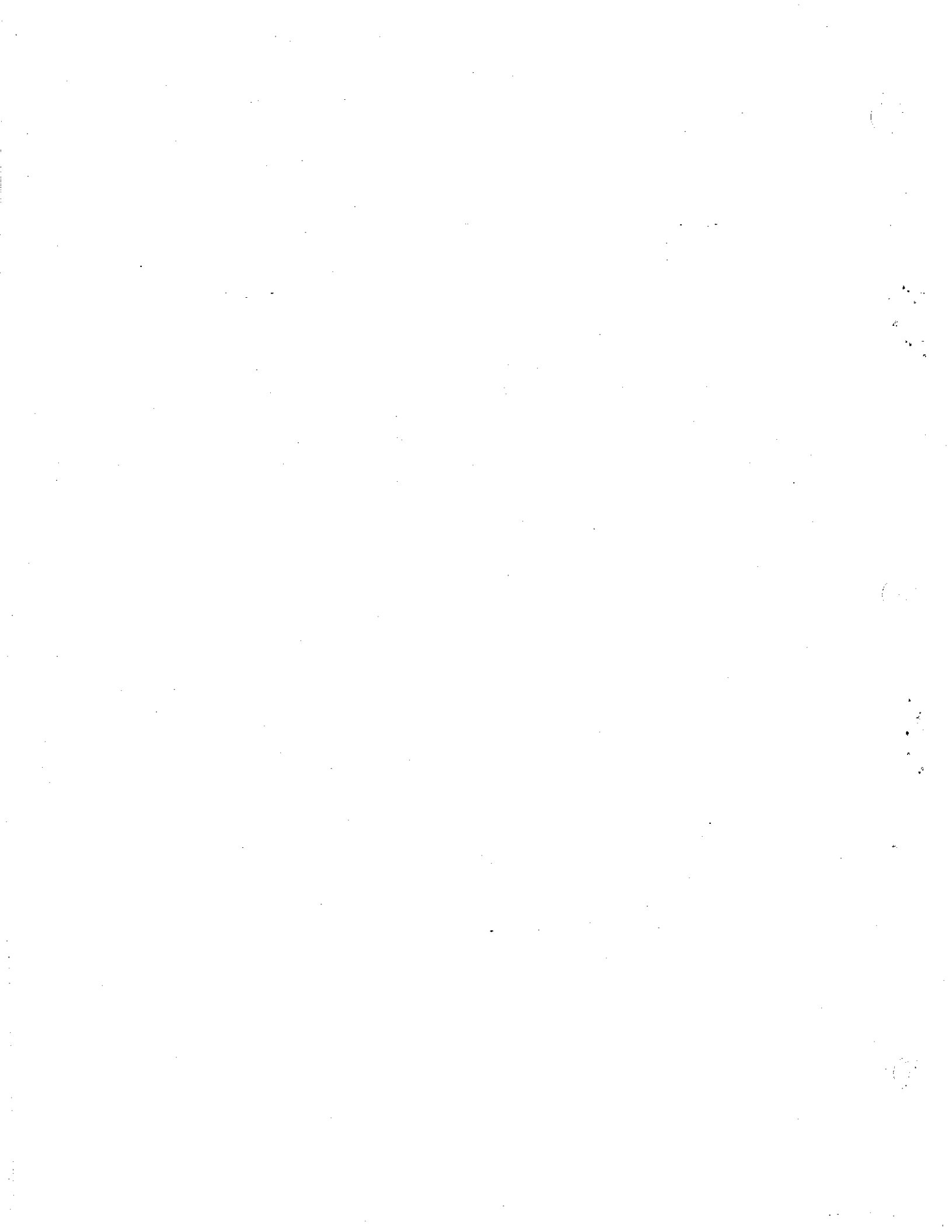

Preface

The Circu-lator Jr., formerly known as Stirr-a-matic Super, has undergone a few changes since it was first designed. We believe that these changes have improved the product's efficiency, capacity, and part availability. Please note these changes, and keep them in mind when ordering parts.

Probably the most obvious change has been the name. The former name, Stirr-a-matic, caused some confusion about the way the machine worked. It is a re-circulation machine, not a stirring device.

At the same time of the name change, we also stopped manufacturing the Regular or 4" center vertical model.

One of the earliest changes on the CL Jr. was in the drive gears. The driven ring gear is now a 'one piece casting'. The motor drive or pinion gear is longer to insure ease of alignment and long service life of the gears.

In order to facilitate working on the gearbox and to make it easier to remove the spider wheel, we changed the 'hex' top shaft to a 'square' shaft. Of course, the bottom coupler on the center vertical changed to a square coupler. (Note: If you need to replace a center vertical flite weldment that has a 'hex' coupler, the replacement will have a square coupler. You will need to replace the top shaft in the gearbox as well.)

Finally, in order to increase the capacity of the CL Jr., we are using the standard Circu-lator tapered sweep. In doing this, we also replaced the CL Jr. base & flange with the standard Circu-lator base & flange. (Note: If you need to replace the tapered sweep, the replacement will be a standard Circulator sweep. You will need to replace the base and flange as well. This change will give the machine greater grain removal capability and add to the utility of the machine.

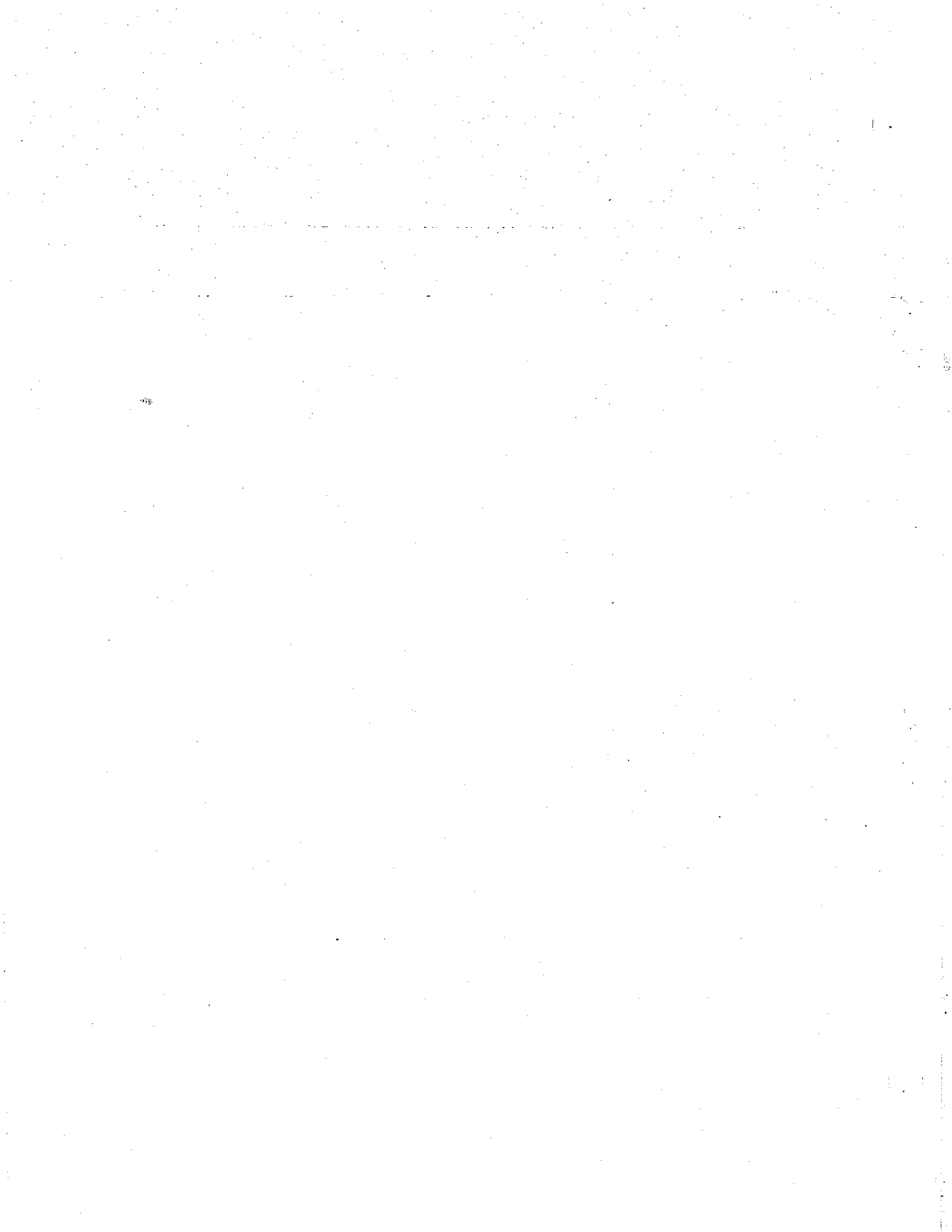

CIRCU-LATOR JR.

ITEM	DESCRIPTION	PART NO.	PAGE NO.
1	Center Vertical Assembly	See Chart	7
2	Gearbox	569E-001A	8
3	Tapered Sweep Assembly	See Chart	6
4	Stand Assembly	See Breakdown	11
5	Track	See Chart	6

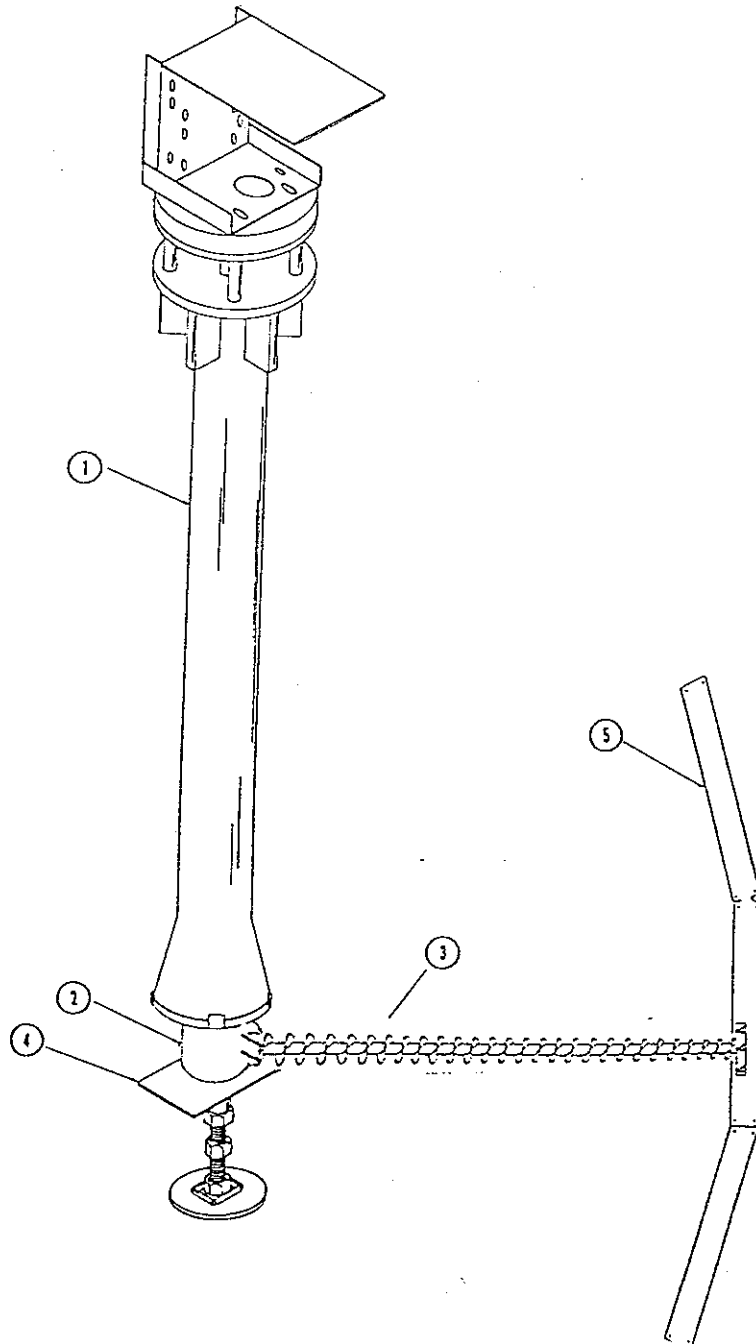

Center Vertical

ITEM	DESCRIPTION	QTY	PART NO.	BREAK-DOWN	
				PART NO.	
1	Motor Cover	1	445-008P		
2	Capscrew, Hx 1/2"-13 x 1, Gr. 2	2	F-1006-45		
3	Nut, Hx Znc Pltd, 1/2"-13 Unc-2B	2	F-1011-05		
4	Motor Mount Weldment	1	570-013W		
5	Motor	1	A/R		
6	Gear, Pinion	1	572-002A		9
7	Key	1	445-035P		
8	Capscrew, Hx 3/8"-16 x 1-1/2", Gr. 2	4	F-1006-27		
9	Lockwasher, 3/8"	4	F-1019-03		
10	Flat Washer, 3/8"	12	F-1009-03		
11	Nut, Hx, Znc Pltd, 3/8"-16 Unc-2B	4	F-1011-03		
12	Top Plate Weldment		570-014W		
13	Support, 3-1/4" Long	6	445-003P		
14	Spacer	3	445-038P		
15	Washer 14 Ga.	*2	F-8003-01		
16	Washer 10 Ga.	*5	F-8003-02		
17	Gear, Driven	1	445-055P		9
18	Middle Plate	1	217-048P		
20	Roll Pin, Double, HD, 3/8" x 1-3/4"	1	F-1036-47		
21	Bearing, 4 Hole Flng, 1-1/4" Bore	1	D-2002-02		
22	Capscrew, Hx 1/2"-13 x 1-1/2", Gr. 2	4	F-1006-47		
23	Nut, Hx, Znc Pltd, 1/2"-13 Unc-2B	2	F-1011-05		
24	Support, 5" Long	6	445-002P		
25	Bottom Plate Weldment	1	435-017W		
26	Capscrew, Hx 3/8"-16 x 1-1/2", Gr. 2	4	F-1006-27		
27	Locknut, Hx 3/8"-16 W/Nyloc	12	F-1239		
28	Bolt, Hx 3/8"-16 x 9", Gr. 2	6	F-1187		
29	Tube & Cone Weldment	1	See Break-Down		7
30	Capscrew, Hx 3/8"-16 x 4", Pltd.	1	F-1206		
31	Flipper	1	See Break-Down		10
32	Bolt, Carriage 5/16"-18 x 3/4", Gr. 2	2	F-1008-13		
33	Nut, Hx, Znc Pltd, 5/16"-18 Nyloc	2	F-1005-02		
34	Flite & Pickup Finger Weldment	1	See Break-Down		7
36	Gear Cover	1	445-036P		
41	Flat Washer	2	F-1009-02		

* Quantities of items 15 or 16 may be varied as necessary to adjust clearances between pickup fingers and cone or spider wheel as required.

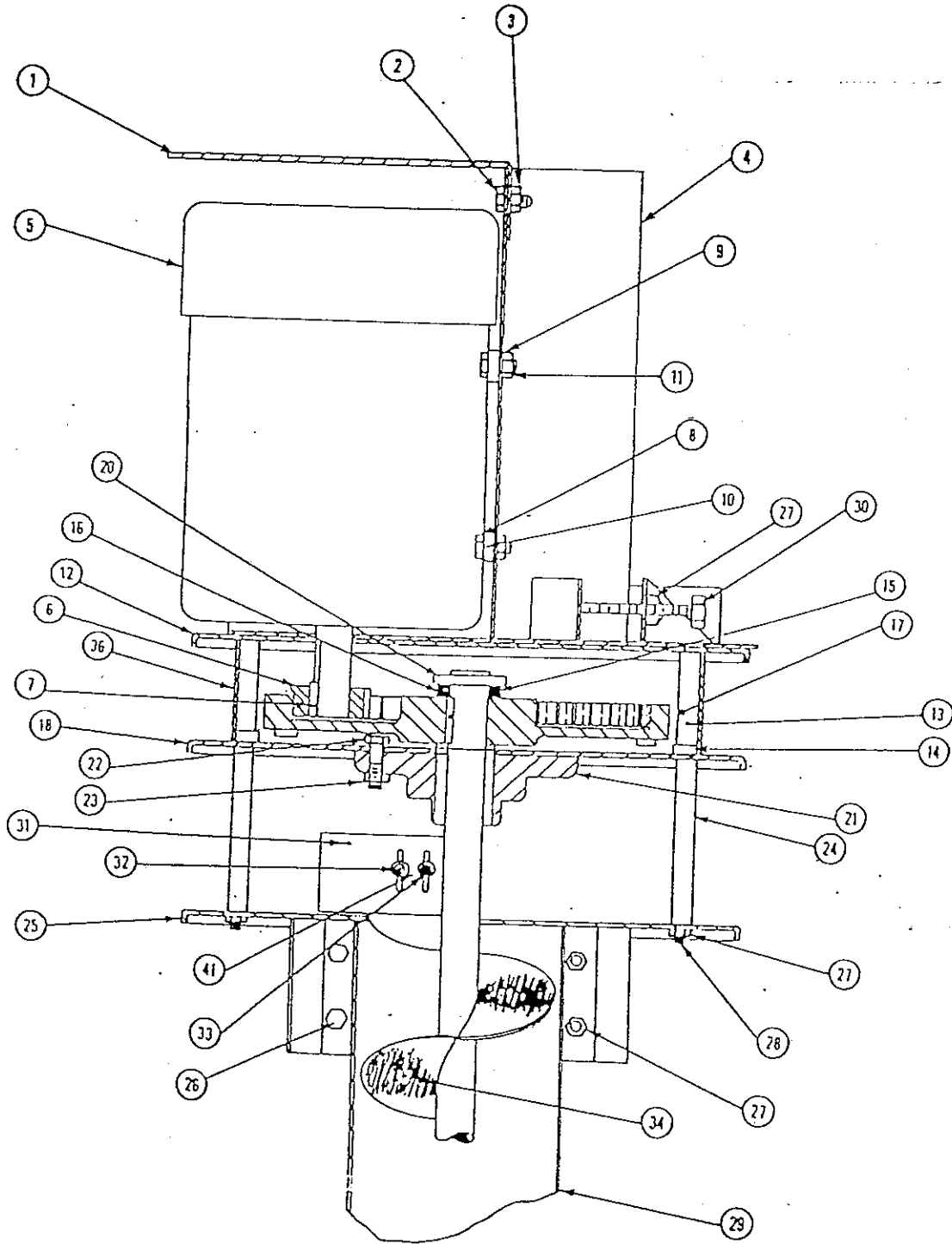

CIRCU-LATOR JR.

SHIVVERS

CORYDON, IOWA

Center Vertical

ITEM	DESCRIPTION	QTY	PART NO.	BREAK-DOWN PART NO.
4	Motor Mount Weldment	1	570-013W	24
5	Motor	1		
6	Gear, Pinion	1	572-002A	9
10	Capscrew, Hx 3/8"-16 x 1, Gr. 2	4	F-1006-25	
12	Top Plate Weldment	1	570-014W	23
13	Support, 3-1/4" Long	6	445-003P	
14	Spacer	3	445-038P	
17	Gear, Driven	1	445-055P	9
18	Middle Plate	1	217-048P	23
19	Key	1	445-042P	
21	Bearing, 4 Hole Flng, 1-1/4" Bore	1	D-2002-02	
24	Support, 5" Long	6	445-002P	
25	Bottom Plate Weldment	1	435-017W	18
29	Tube & Cone Weldment	1	See Break-Down	7
31	Flipper	1	See Break-Down	10
32	Bolt, Carriage 5/16"-18 x 3/4", Gr. 2	2	F-1008-13	
33	Nut, Hx, Znc Pltd, 5/16"-18 Nyloc	2	F-1005-02	
35	Capscrew, 3/8"-16 x 1, Gr. 2	4	F-1006-25	
36	Gear Cover	1	445-036P	
37	Spring, Ext, 3-1/2", 2 Hooks	1	H-6002-01	
39	Socket Head Setscrew, 1/4"-28 x 1/4"	1	F-1252	
40	Decal, "Support Unit Here"	2	P-8247	
41	Washer, Flat, Std, Steel, 5/16"	2	F-1009-02	

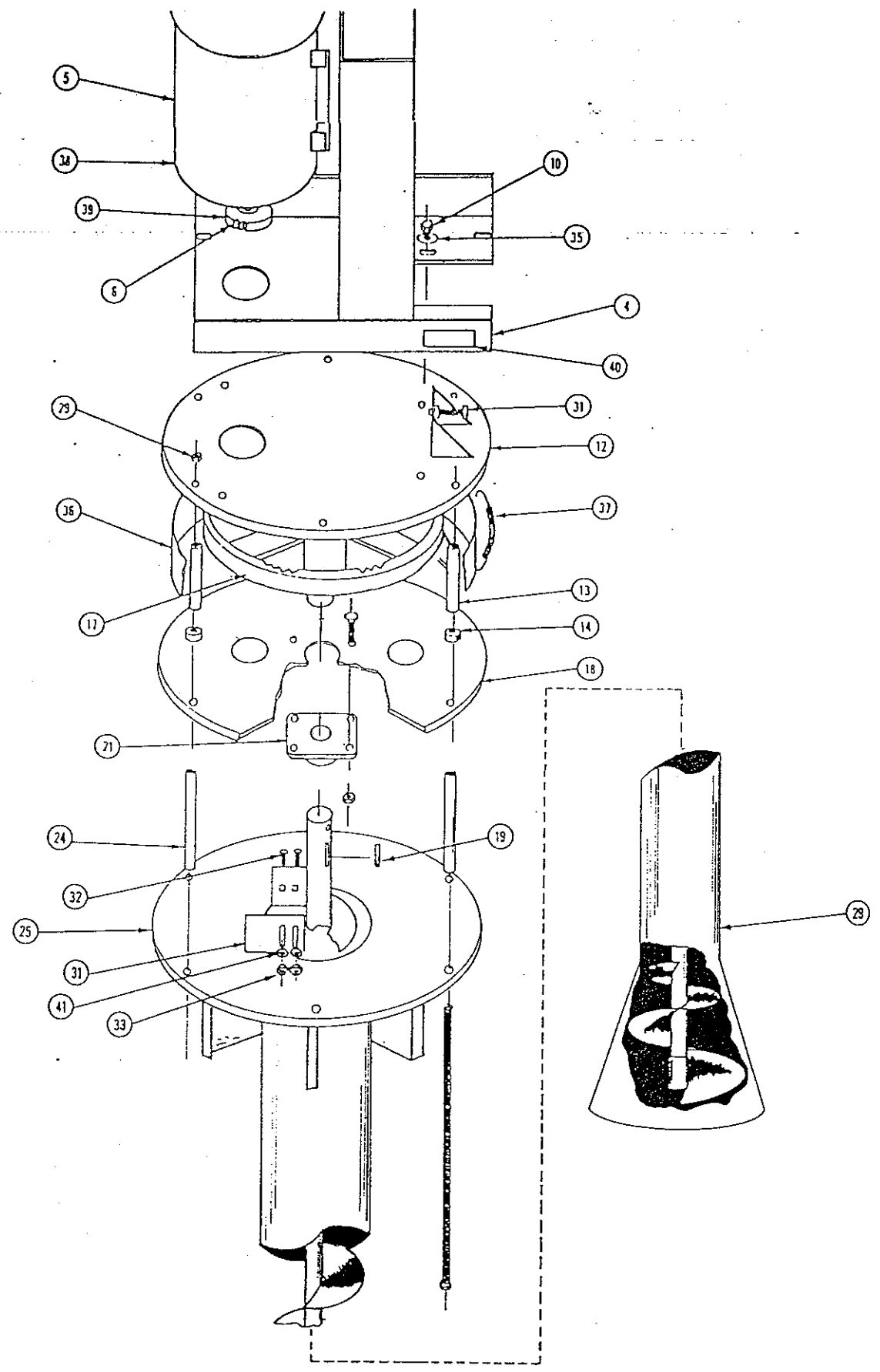

TAPERED SWEEP AUGERS

CORYDON, IOWA

208 REGULAR Tapered Sweeps

210 HARD SURFACED Tapered Sweeps

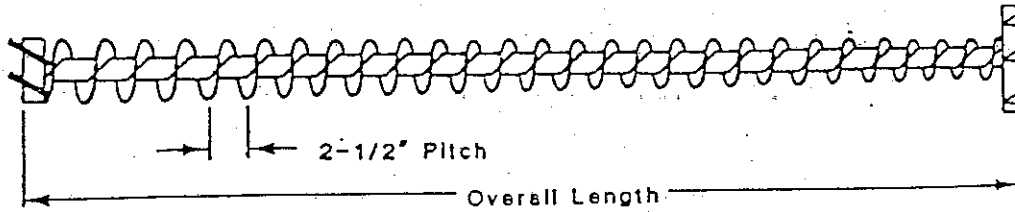

PART NUMBER		OVERALL LENGTH
BIN DIAMETER	ASSEMBLY	
17' 07"-	001A	7' 10-3/8"
18' 00"-	001A	8' 00-7/8"
18' 07"-	001A	8' 04-3/8"
19' 00"-	001A	8' 06-7/8"
20' 00"-	001A	9' 00-7/8"
21' 00"-	001A	9' 06-7/8"
21' 04"-	001A	9' 08-7/8"
21' 08"-	001A	9' 10-7/8"
21' 10"-	001A	9' 11-7/8"
22' 00"-	001A	10' 00-7/8"
22' 06"-	001A	10' 03-7/8"
22' 09"-	001A	10' 05-3/8"
23' 06"-	001A	10' 09-7/8"
24' 00"-	001A	11' 00-7/8"
24' 09"-	001A	11' 05-3/8"
25' 00"-	001A	11' 06-7/8"
26' 05"-	001A	12' 03-3/8"
26' 09"-	001A	12' 05-3/8"
26' 10"-	001A	12' 05-7/8"
27' 00"-	001A	12' 06-7/8"
27' 10"-	001A	12' 11-7/8"

Note: Stirr-A-Matic and CL Jr. (through 1989) used a grooved Base & Flange to couple to a CL Jr. Sweep (567 or 568 Series).

When replacing a sweep with a current Circu-lator sweep (208 or 210), the Base and Flange must be changed on the Gearbox. Order a 423-022-001A, B & F Kit.

WEAR TRACK

Bin Diameter	Track Bundle	Pcs.
17'7" - 19'	205A-001A	15
20' - 22'9"	205B-001A	18
23'6" - 25'	205C-001A	20
26'5" - 27'10"	205D-001A	22

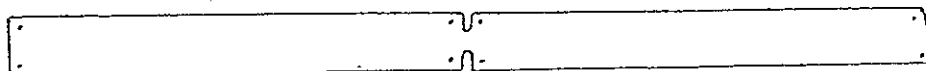

CORYDON, IOWA

CIRCU-LATOR JR.

CENTER VERTICAL FLITE WELDMENT, TUBE WELDMENT,
AND COMPLETE ASSEMBLY

FLITE

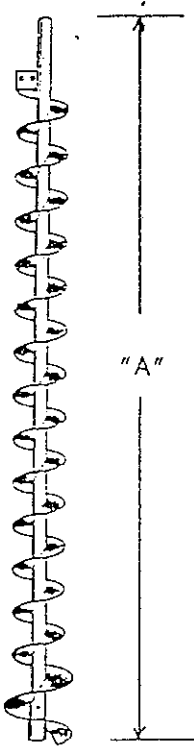

TUBE

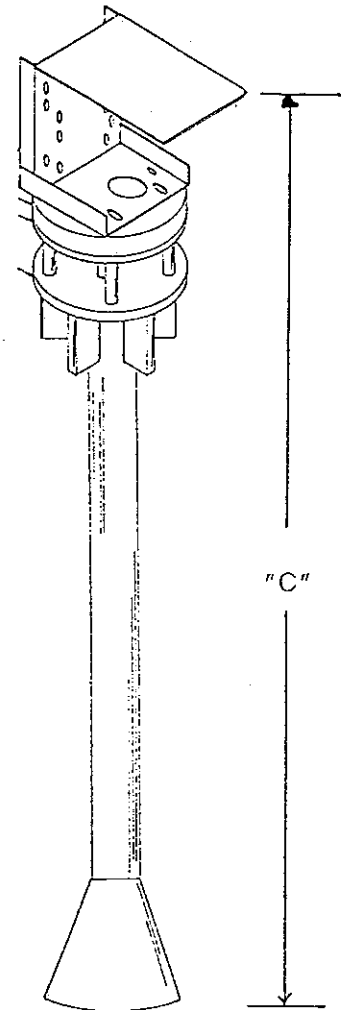
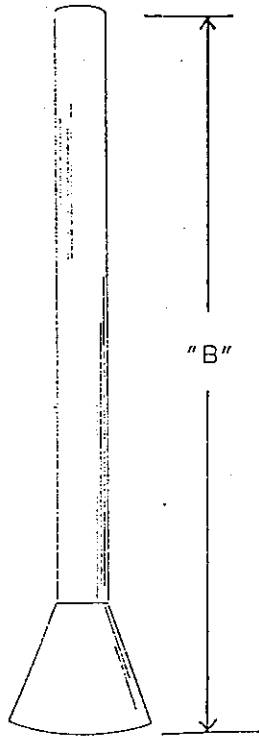

FLITE *

TUBE

OVERALL ASSY.

Part No.	Length "A"	Part No.	Length "B"	Part No.	Length "C"
571K-003W	8' 5-5/16"	445A-029W	8' 11/16"	571K-001A	10'11"
571L-003W	9' 9-5/16"	445B-029W	9' 4-11/16"	571L-001A	12'3"
571M-003W	11' 9-5/16"	445C-029W	11' 4-11/16"	571M-001A	14'3"
571N-003W	14' 6-5/16"	445D-029W	14' 1-11/16"	571N-001A	17'0" SHORT
571O-003W	15' 6-5/16"	445E-029W	15' 1-11/16"	571O-001A	18'0" MEDIUM
571P-003W	16' 2-5/16"	445F-029W	15' 9-11/16"	571P-001A	18'8" TALL
571Q-003W	18' 5/16"	445G-029W	17' 7-11/16"	571Q-001A	20'6" X-TALL
571R-003W	13' 1-5/16"	445H-029W	12' 8-11/16"	571R-001A	15'7"

* Hard Surfaced center vertical auger flite weldments available.
Please ask order desk.

GEARBOX & SPIDER WHEEL ASSEMBLY

SHIVVERS
CORYDON, IOWA

ITEM	DESCRIPTION	QTY	PART NO.
1	Spider Wheel Assembly, Regular	1	423-068-001A
2	Gearbox Assembly, Regular	1	569E-001A

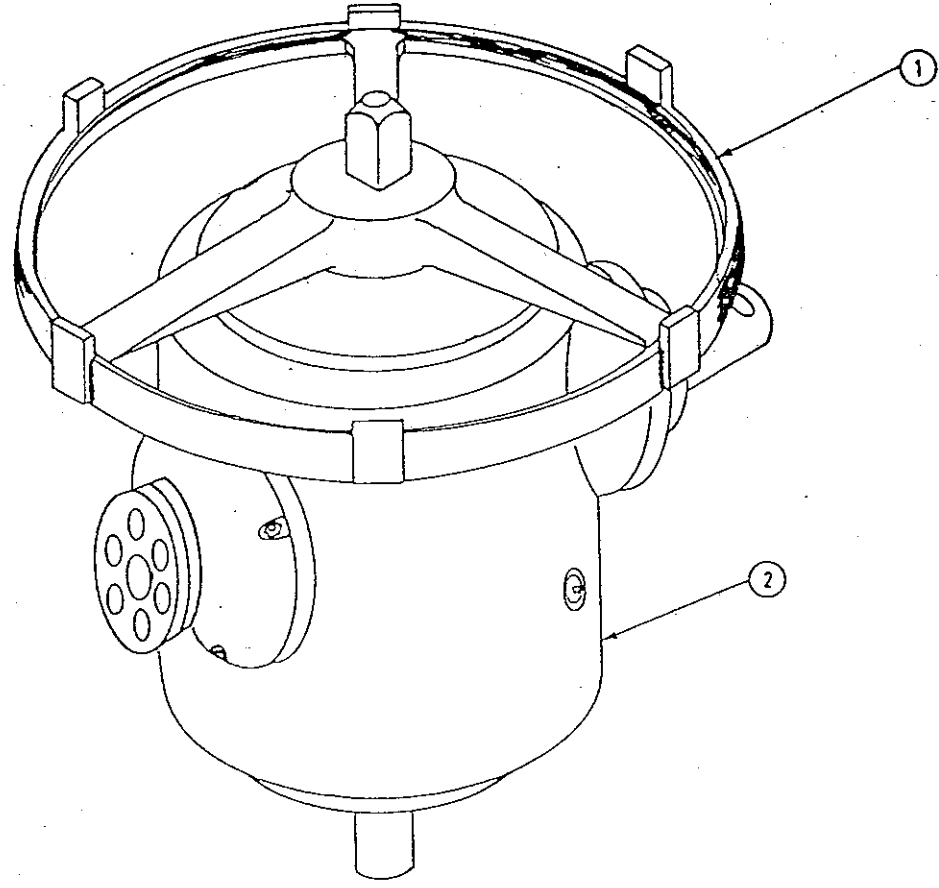

NOTE: Any Circu-lator Jr. made after 1989 uses a standard Circu-lator Base and Flange (420-022-001A), to couple to a standard (208 or 210) tapered sweep. Units made in 1989 and before used a grooved Base & Flange (423-079-001A), to couple to a Jr. Sweep (567 or 568).

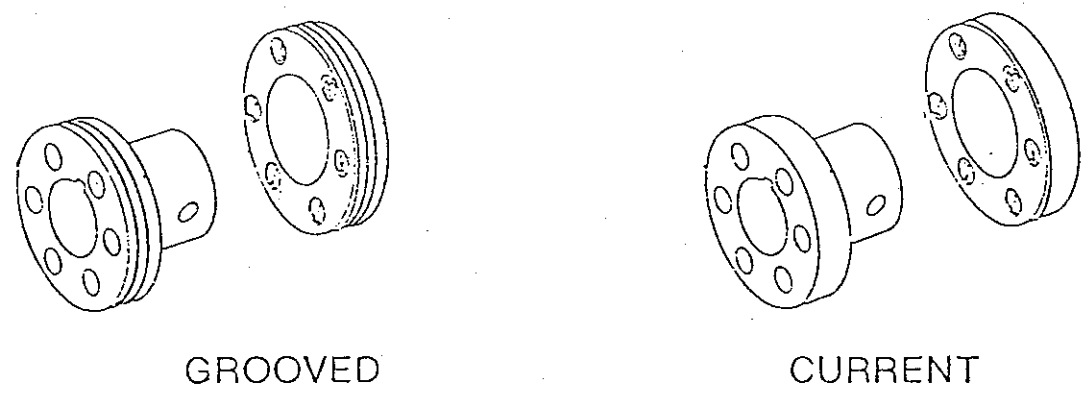

CORYDON, IOWA

PINION GEAR & RING GEAR

ITEM	DESCRIPTION	QTY	PART NO.
1	Pinion Gear Assembly	1	572-002A
	Gear, Pinion 1-1/8" Bore	1	445-057P
	Key, 1/4x3/16x2	1	445-035P
	Screw, Set 1/4-28x1/4	2	F-1252
2	Driven Gear, Ring	1	445-055P

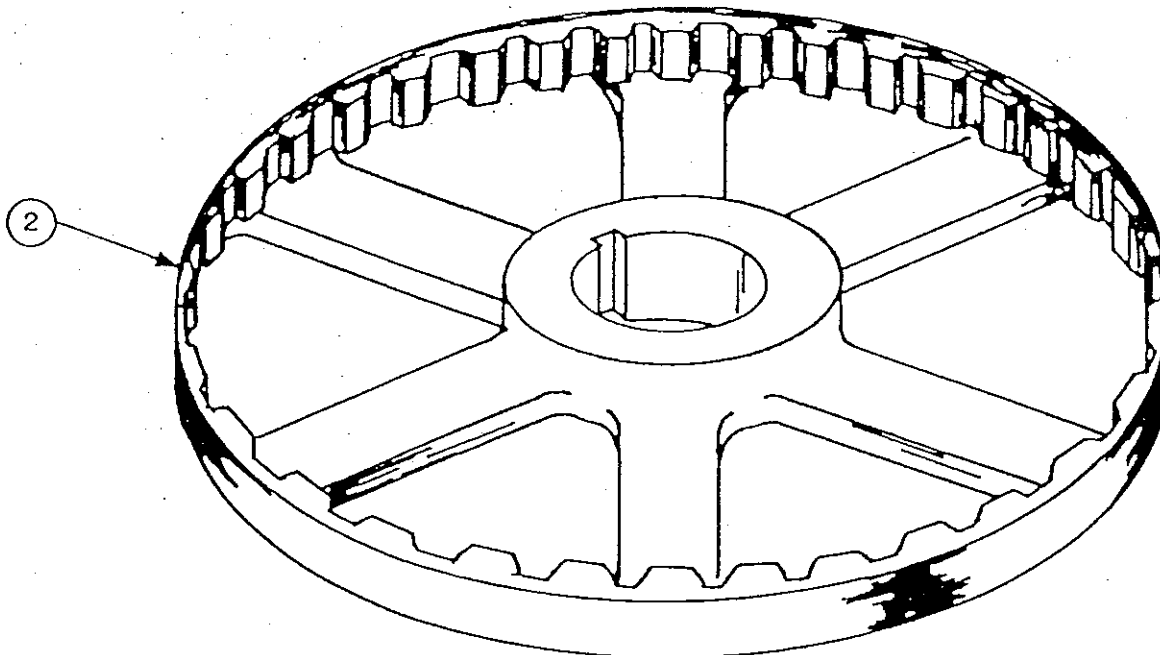
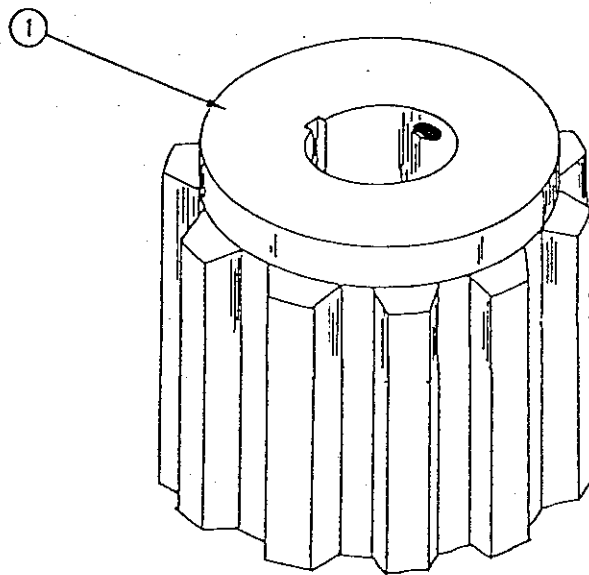

FLIPPERS

SHIVERS

CORYDON, IOWA

ITEM	DESCRIPTION	QTY	PART NO.
1	Flipper, Bin Diameters 18' thru 21'	1	572-014P
2	Flipper, Bin Diameters 21' thru 24'	1	572-010P
3	Flipper, Bin Diameters 24' thru 27'	1	572-011P

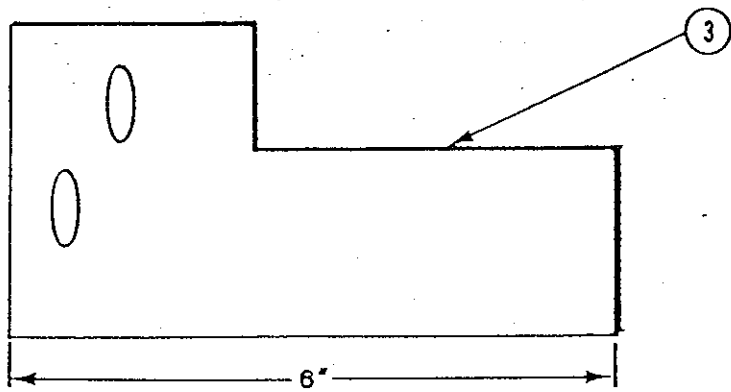
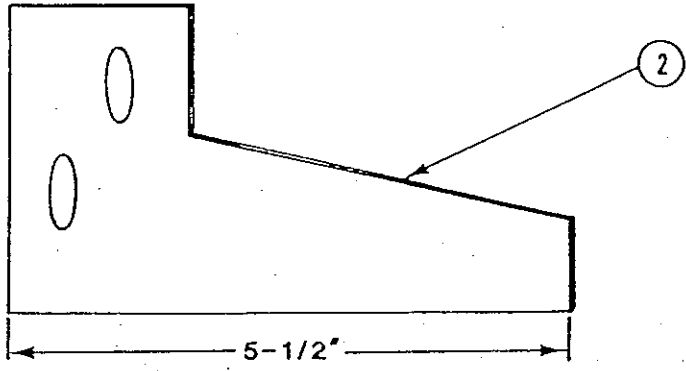
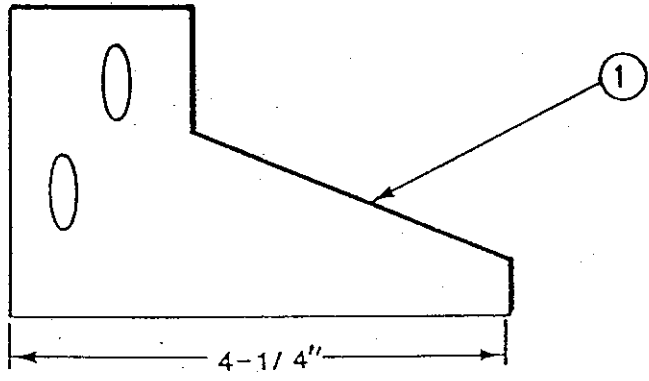

CORYDON, IOWA

ITEM	DESCRIPTION	QTY	PART NO.
1	Stand Weldment	1	440-002W
2	Nut, Hx 1-1/2"-6 Unc-2B	1	F-1182
3	Rod Weldment	1	440-007W
4	Plate Weldment, Foot	1	440-014W

