

CONTROLLED FLOW GRAIN SPREADER PARTS MANUAL
653E-001A -2HP CFGS
653F-001A-CFGS CONTROL BOX
653G-001A-CFGS PAN

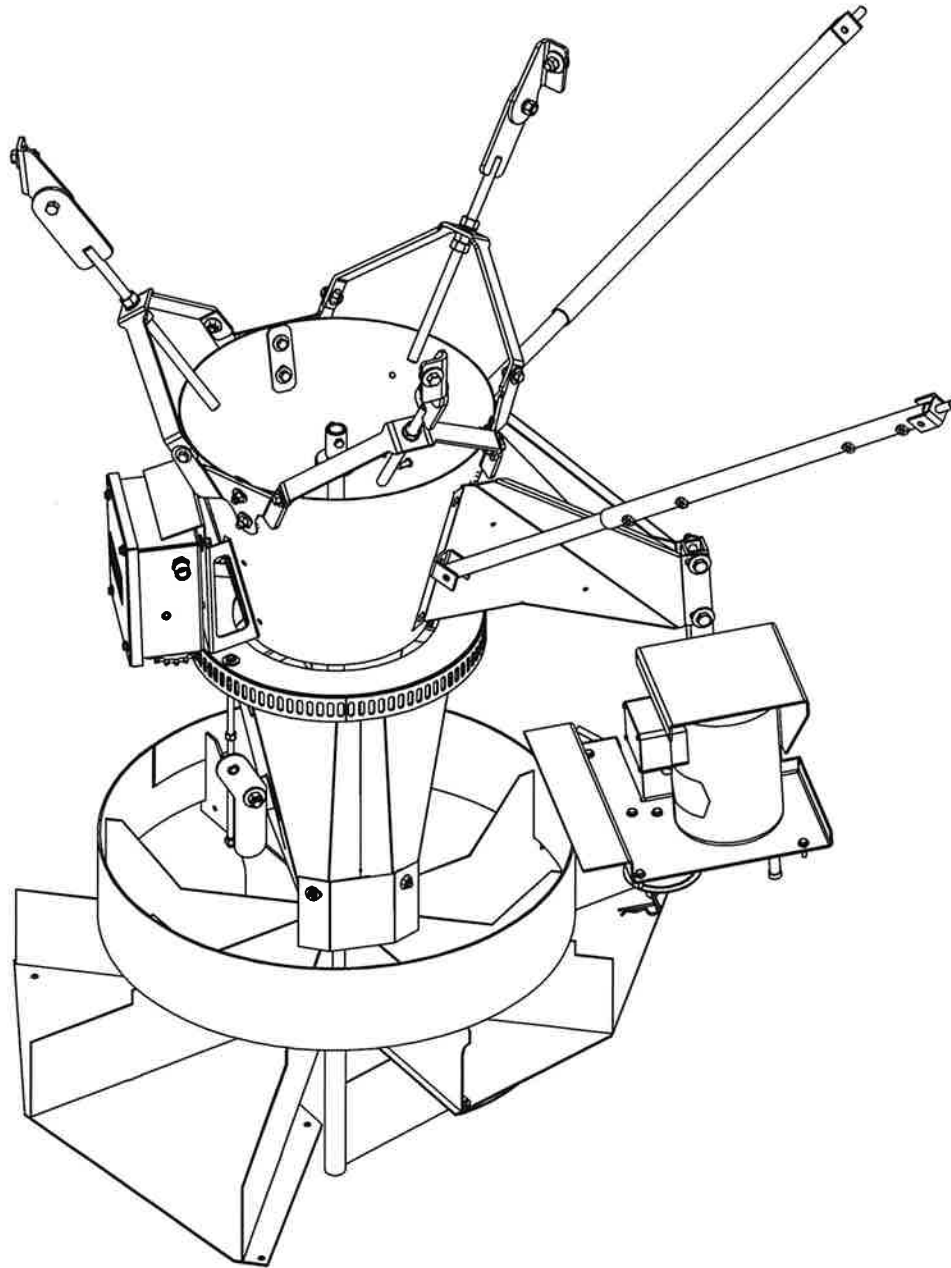

P-11857
1/31/2020

MAIN ASSEMBLY INDEX

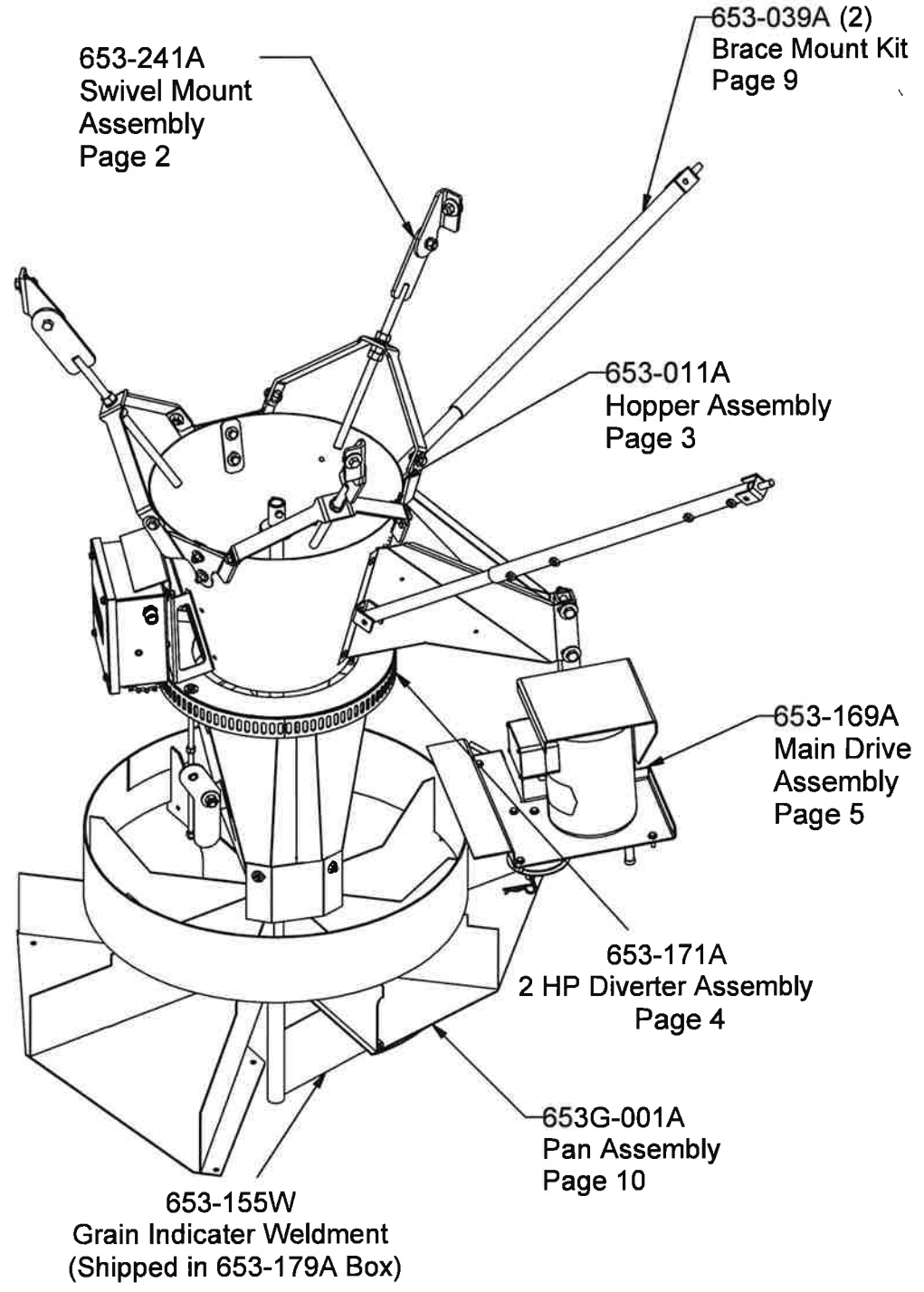

**SWIVEL MOUNT KIT
653-241A
(Shipped in 653-179A Box)**

653-241A replaces
653-094A.

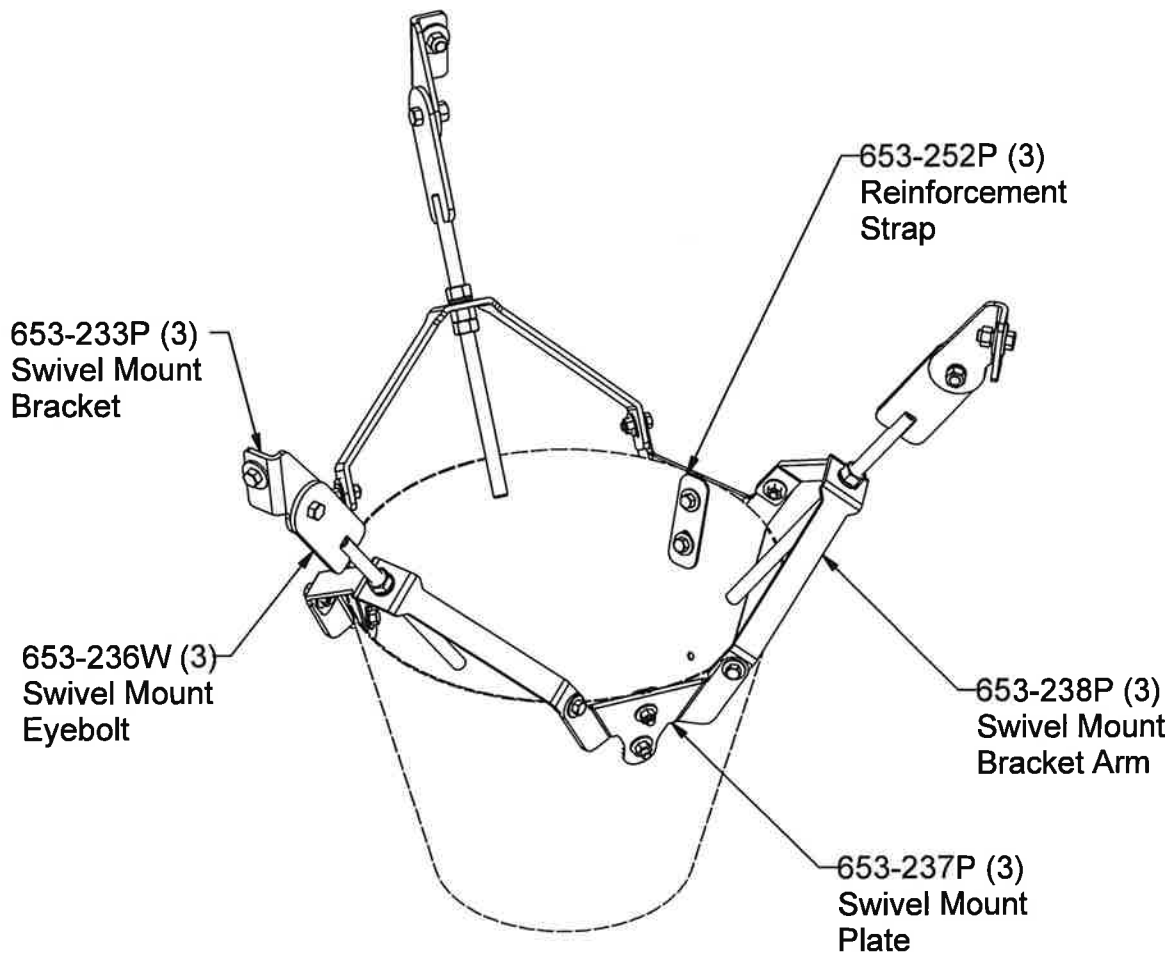

HOPPER DIVERTER ASSEMBLY 653-208A

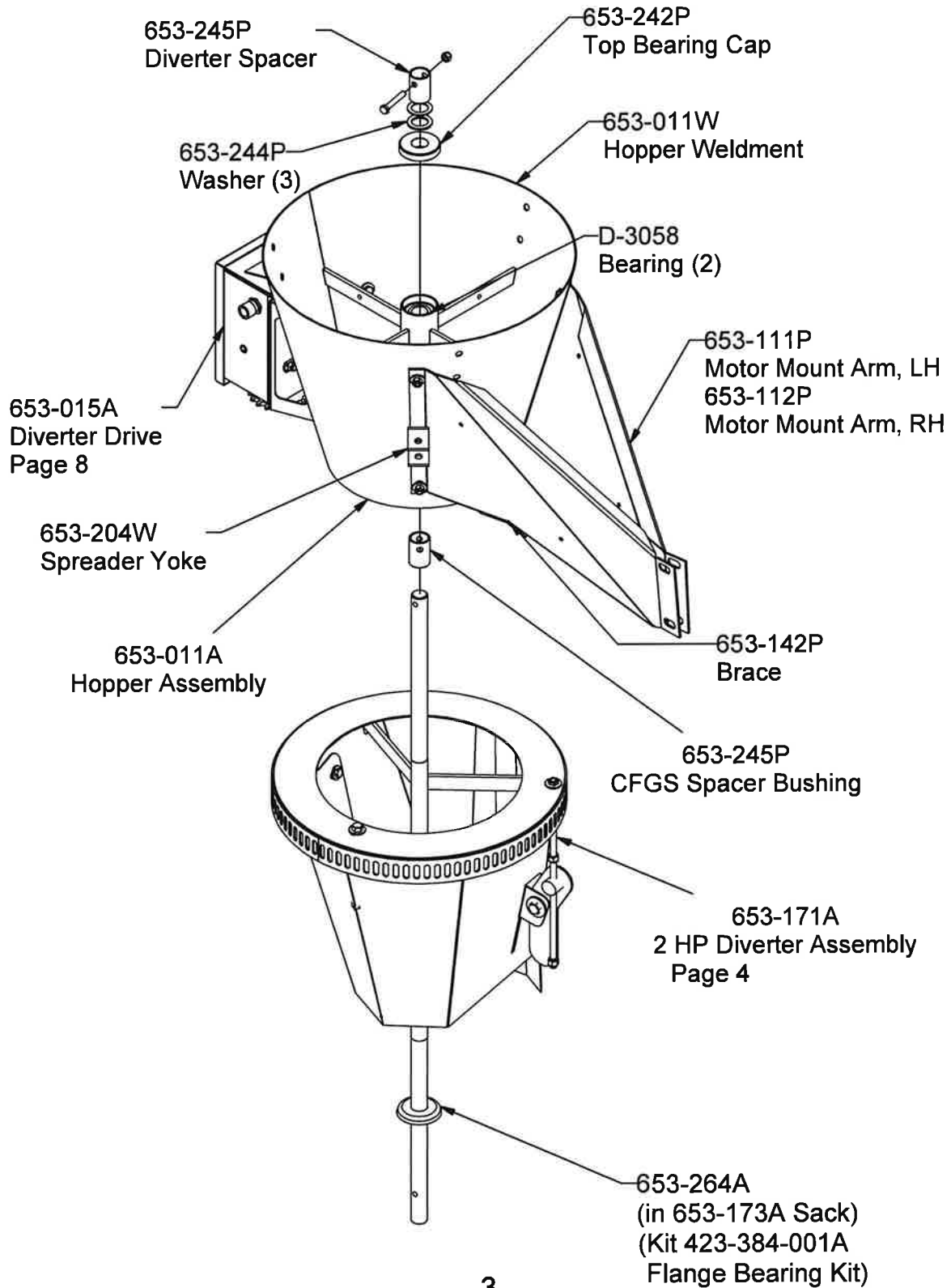

DIVERTER HOPPER ASSEMBLY 653-171A

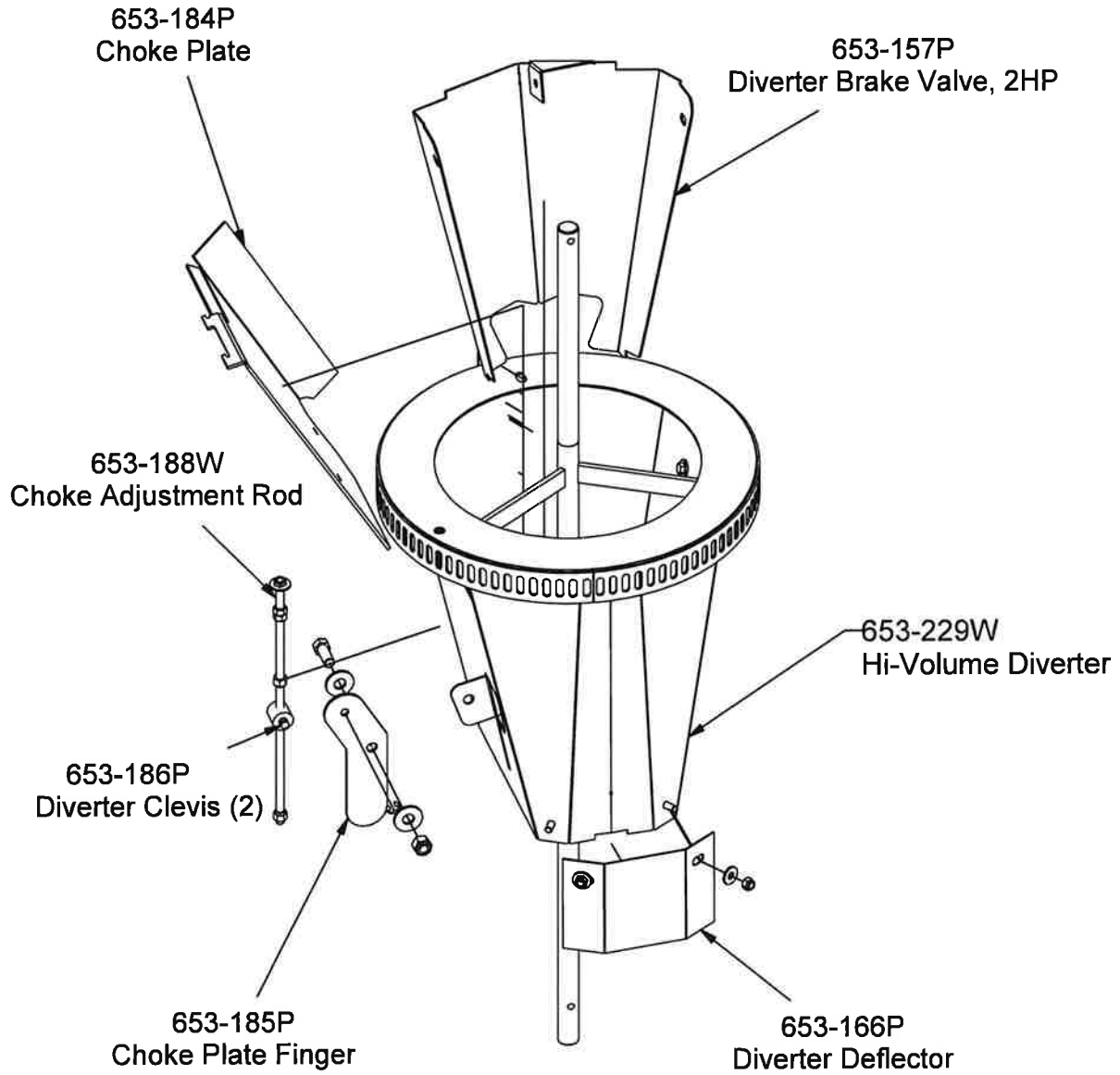

MAIN DRIVE ASSEMBLY 653-169A

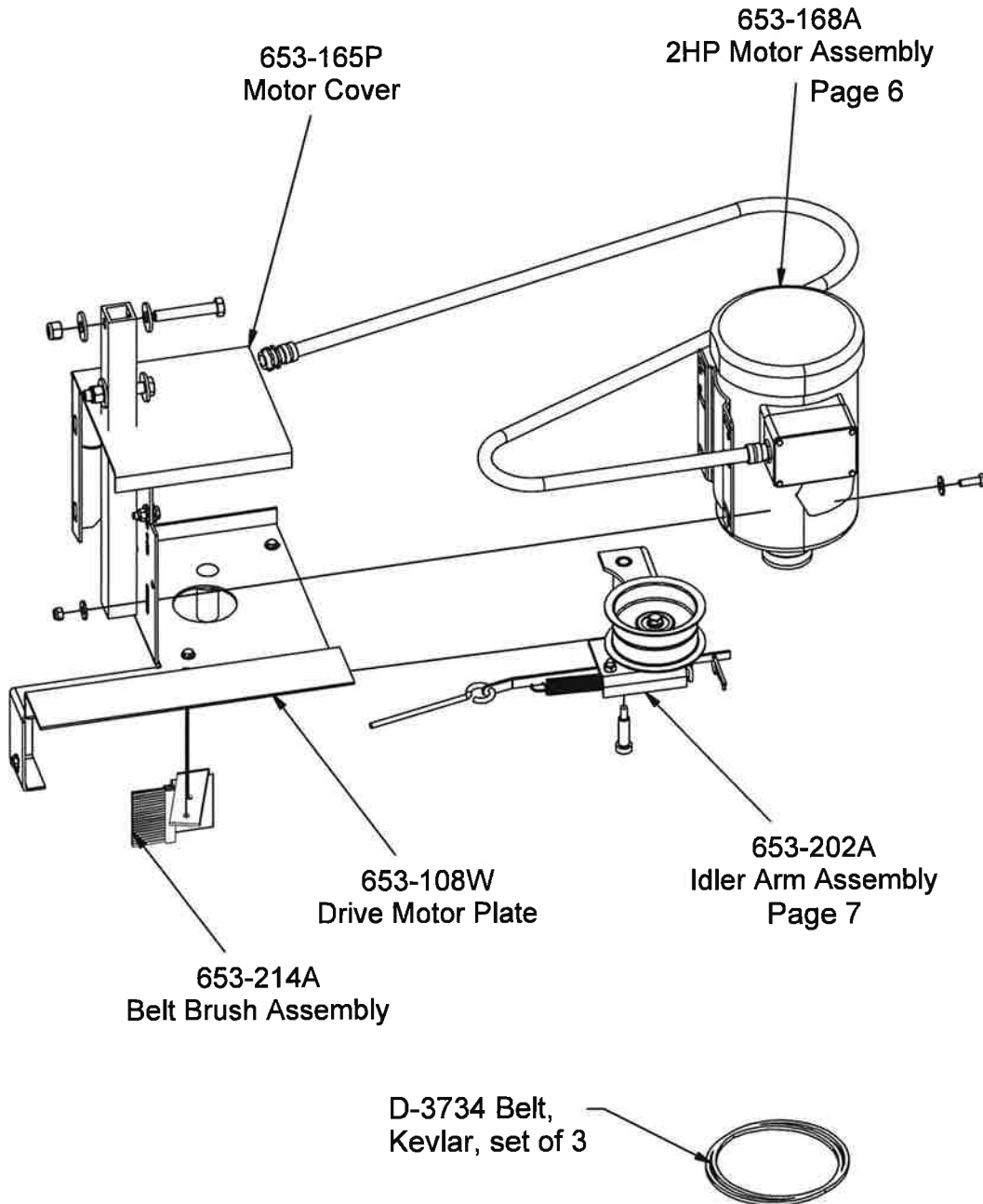

2HP MOTOR ASSEMBLY 653-168A

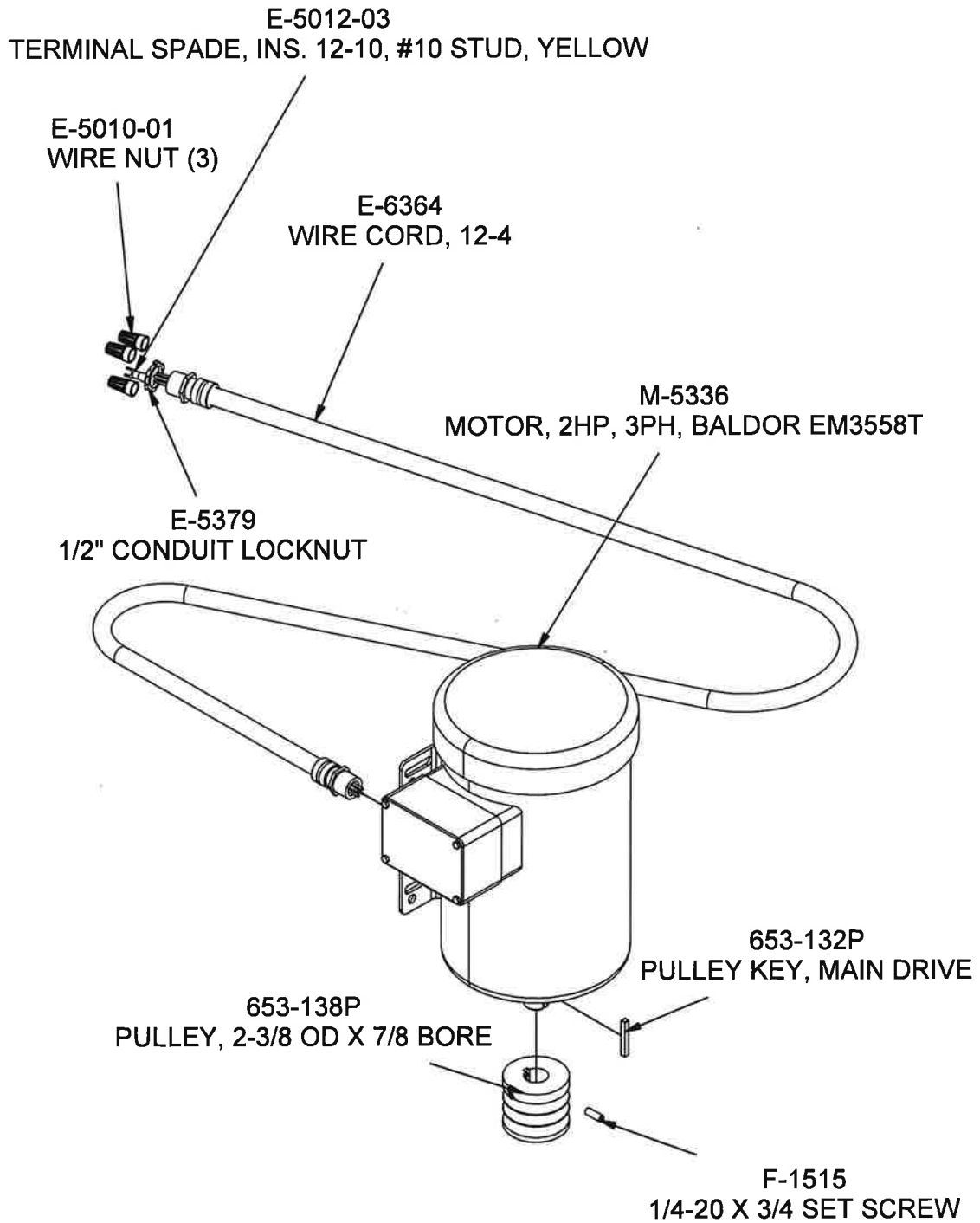

IDLER ARM SUB-ASSEMBLY 653-202A

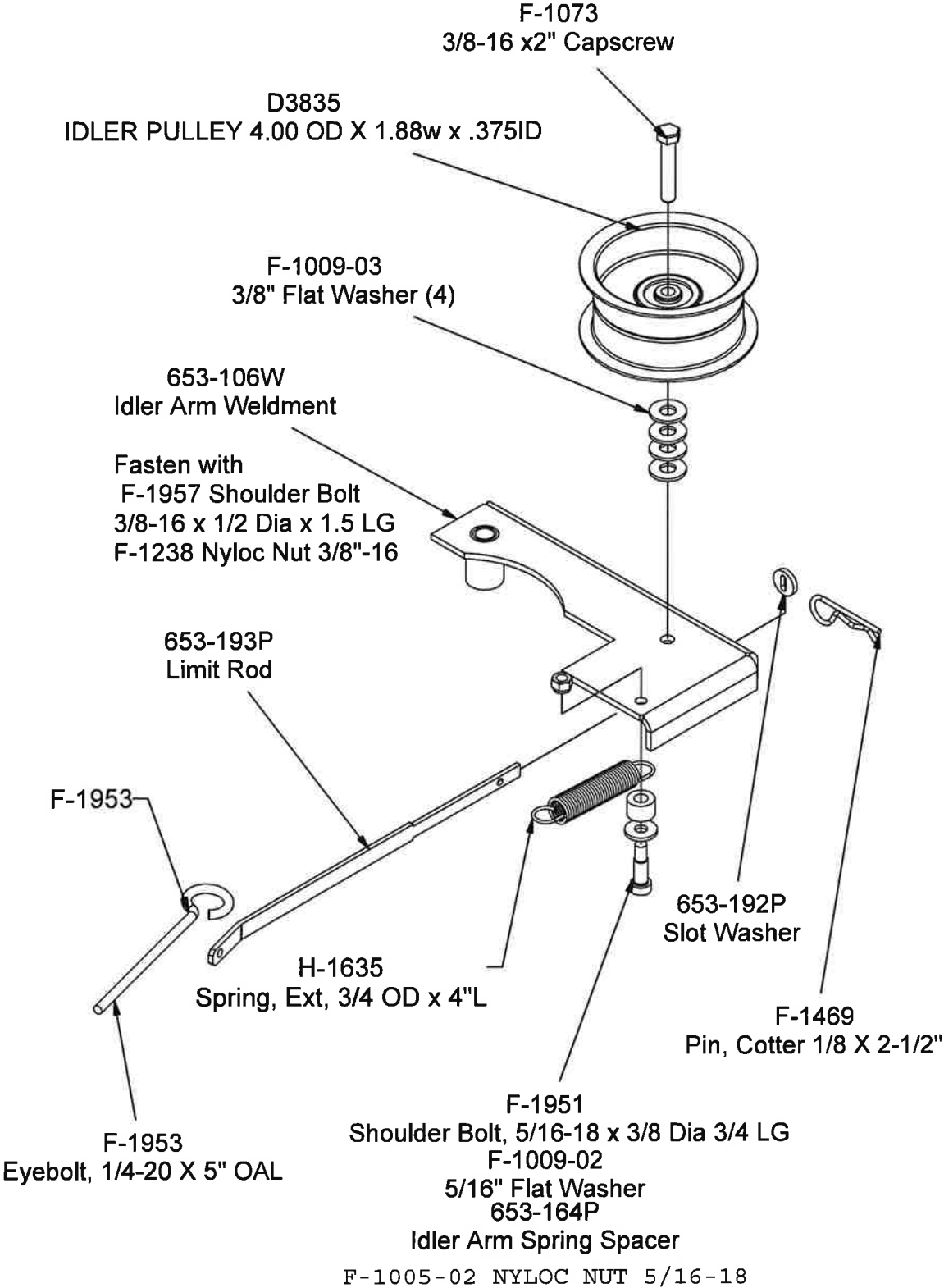

653-015A DIVERTER DRIVE ASSEMBLY

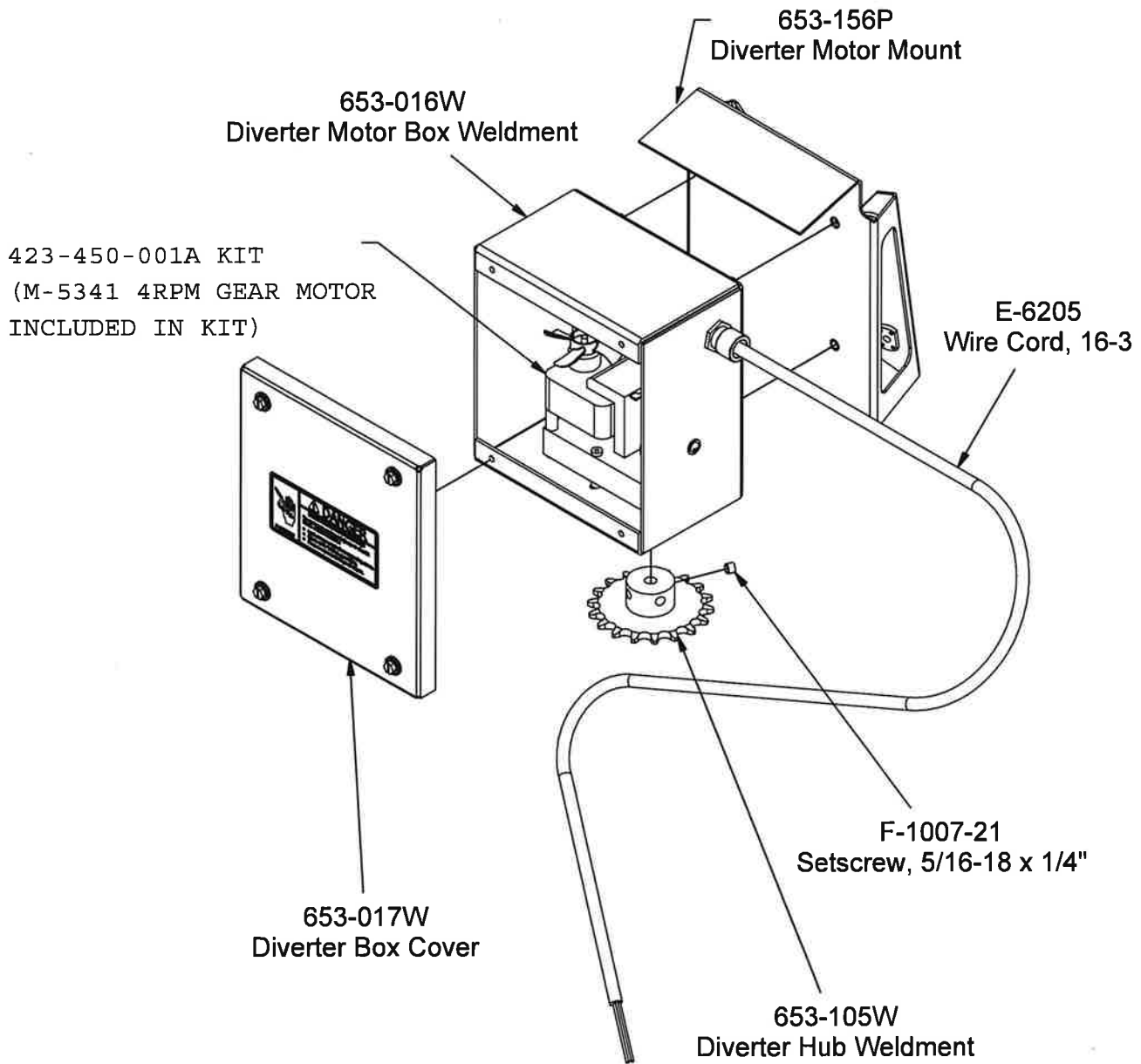

BRACE MOUNT KIT
653-039A
(Shipped in 653-179A box)

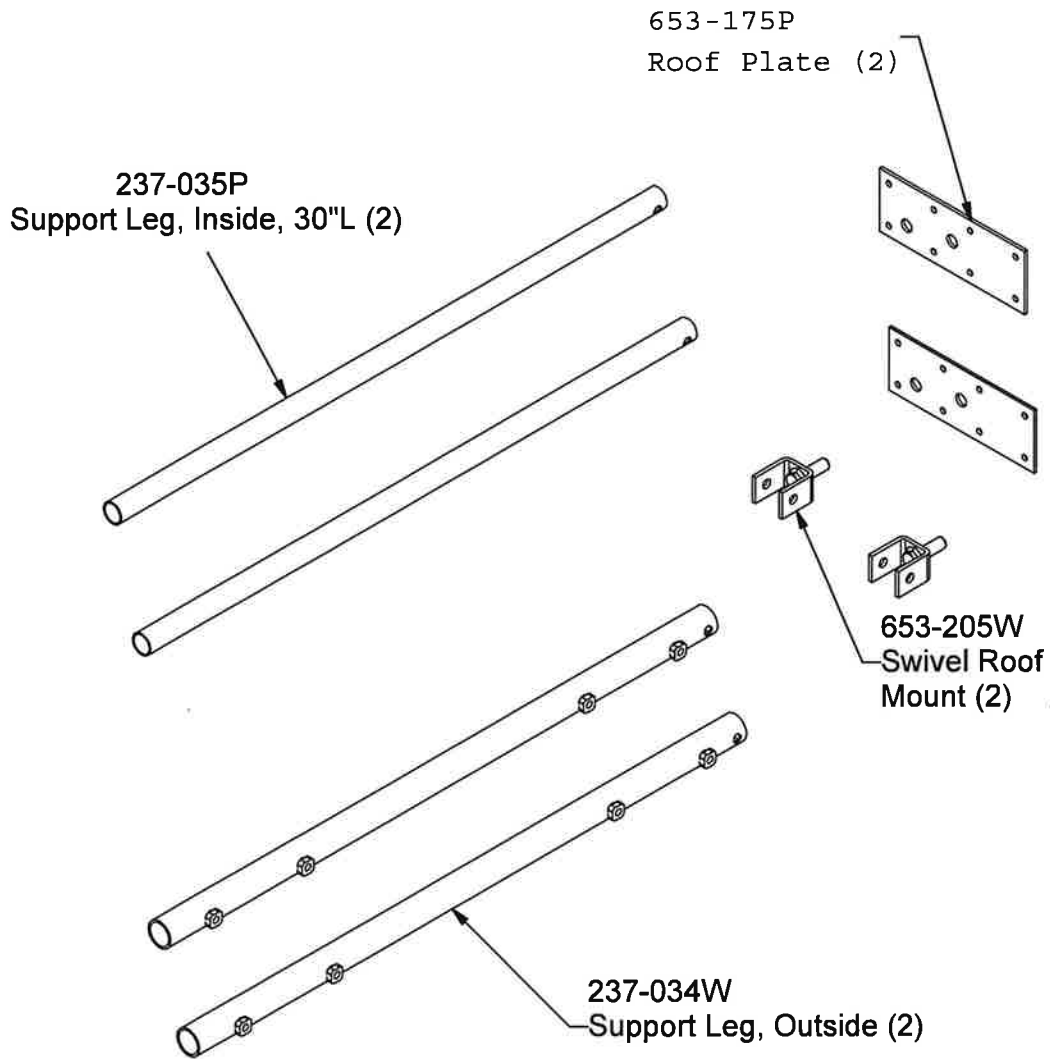

PAN ASSEMBLY
653G-001A

653-206W
Pan Assembly Weldment

D-3735
BEARING

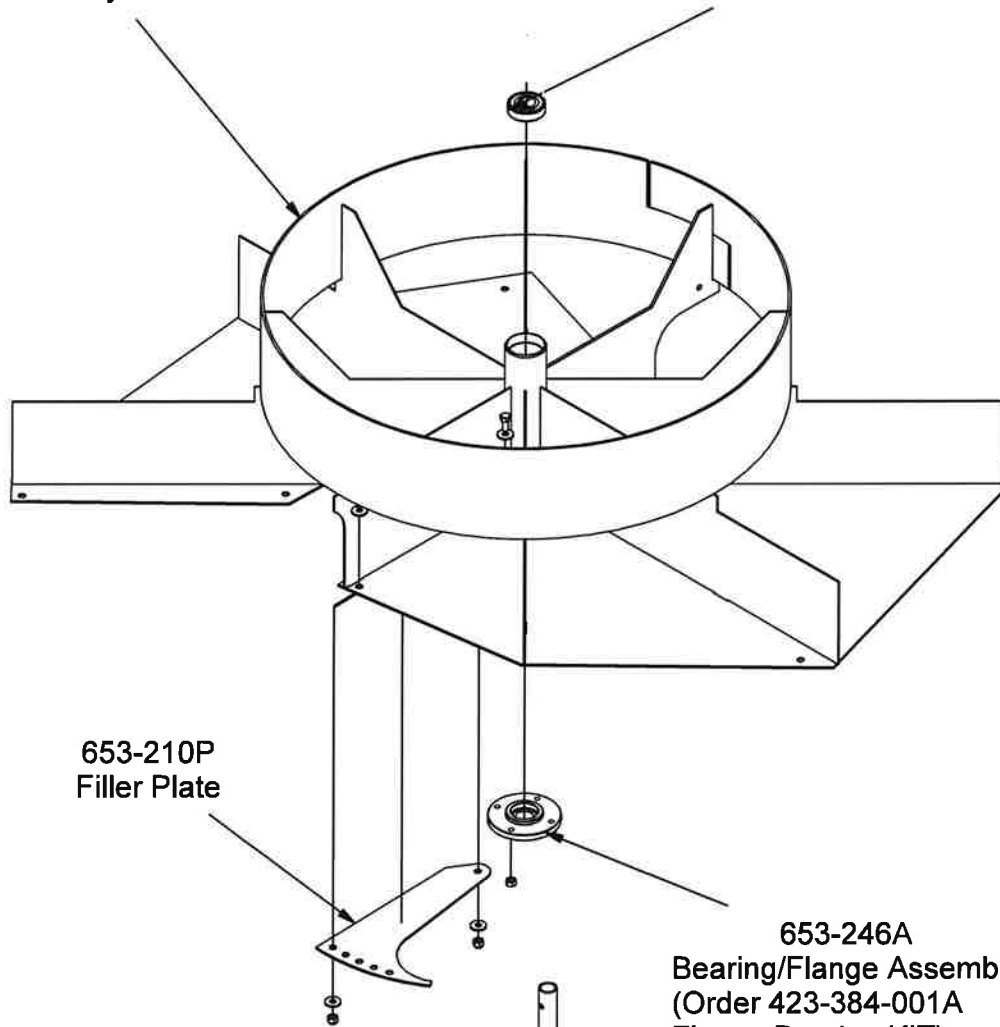

653-210P
Filler Plate

653-246A
Bearing/Flange Assembly
(Order 423-384-001A
Flange Bearing KIT)

(Not sold with 653G-001A)
653-155W, Grain Indicator
shipped in box 653-179A

653F-001A
CONTROL BOX ASSEMBLY 653-133A

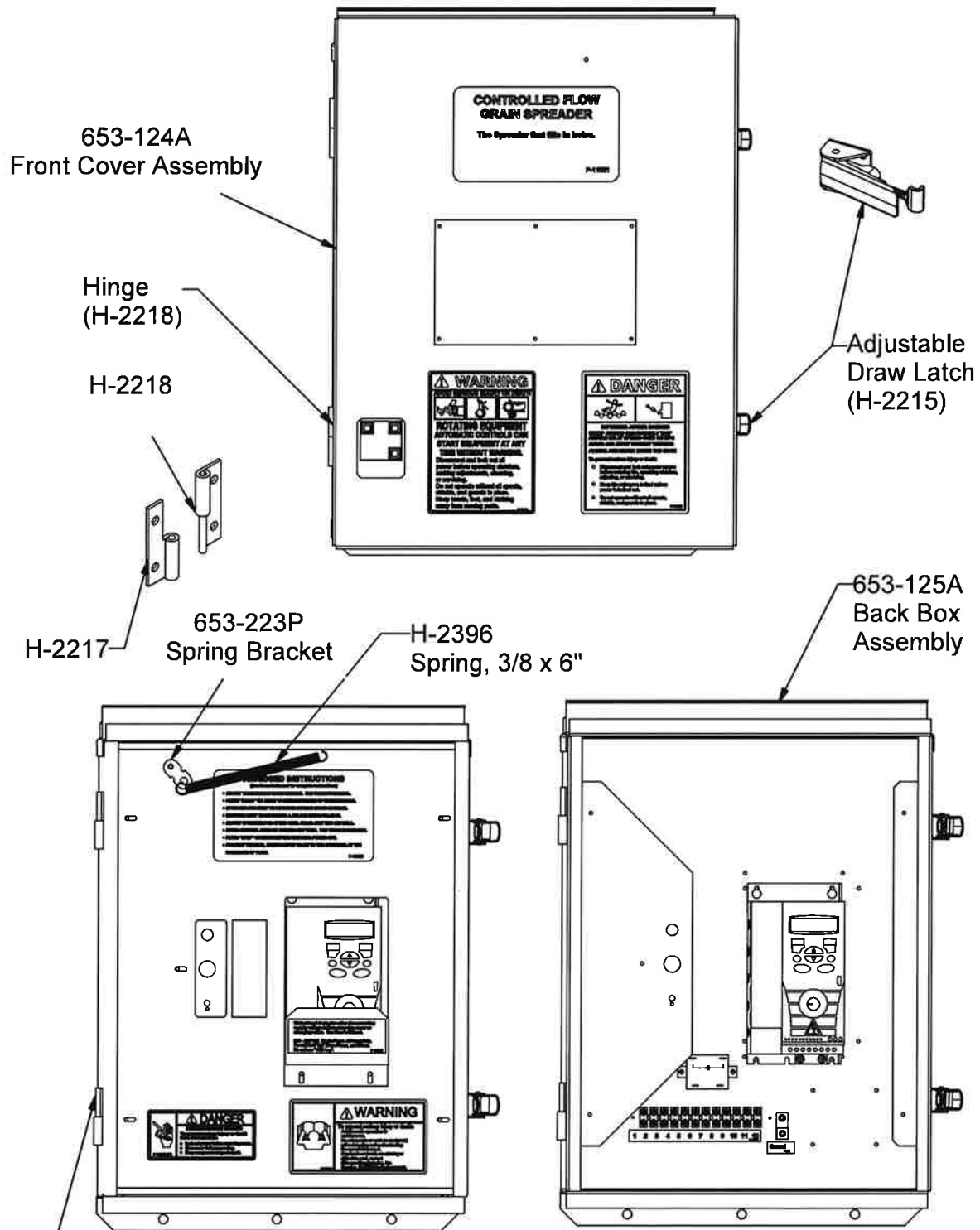

Hinge
(H-2217)

Drive Cable Assembly
653-135A
Switch Box Cable
E-6251, 50'

IDENTIFICATION OF PARTS

(ELECTRICAL CONTROL BOX for ABB DRIVE)

(Started January 2013)

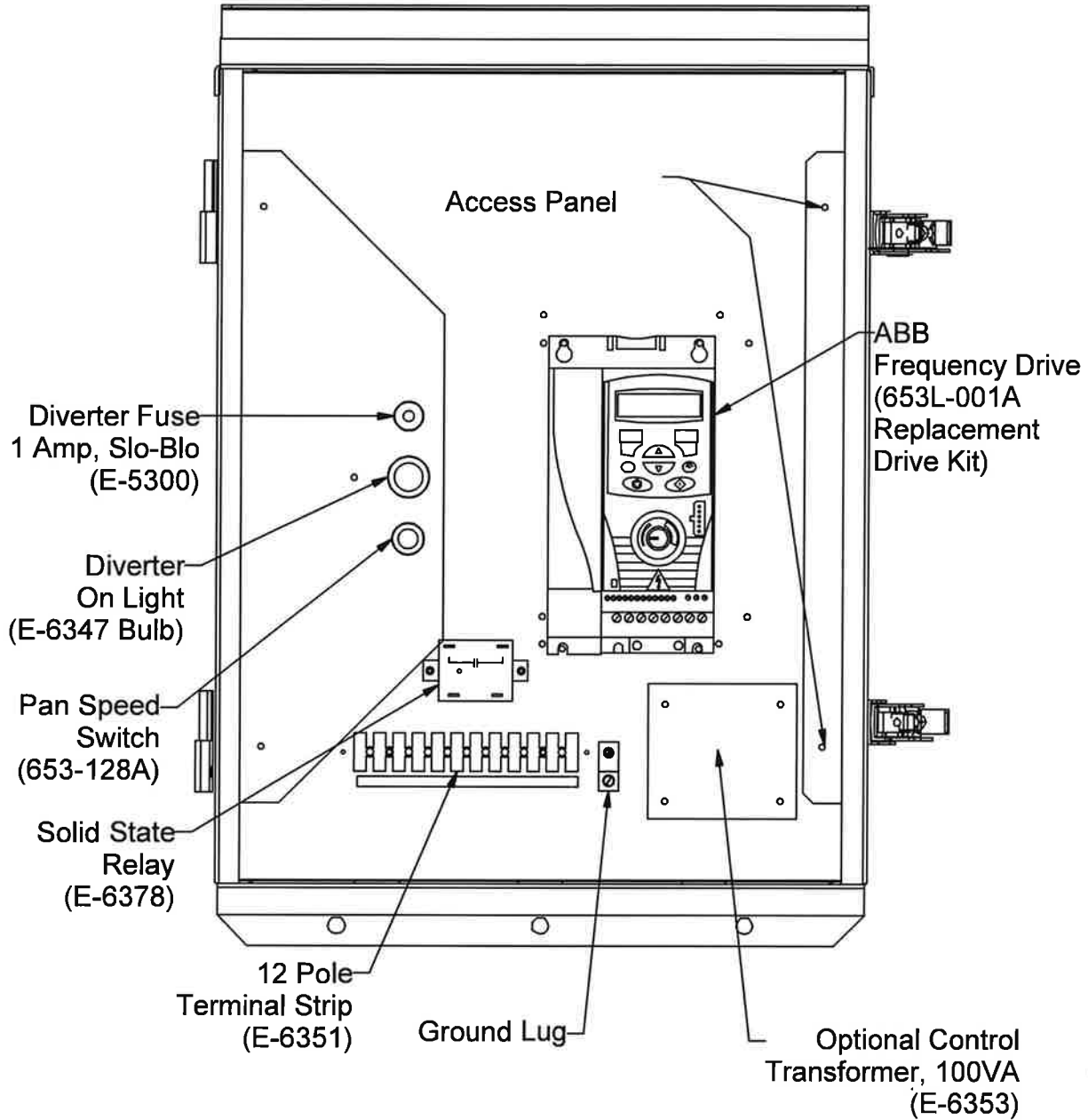

REPLACE MVX9000 (BLACK) WITH
653K-001A (ABB DRIVE CONVERSION KIT)

IDENTIFICATION OF PARTS (SWITCH BOX, 653-126A)

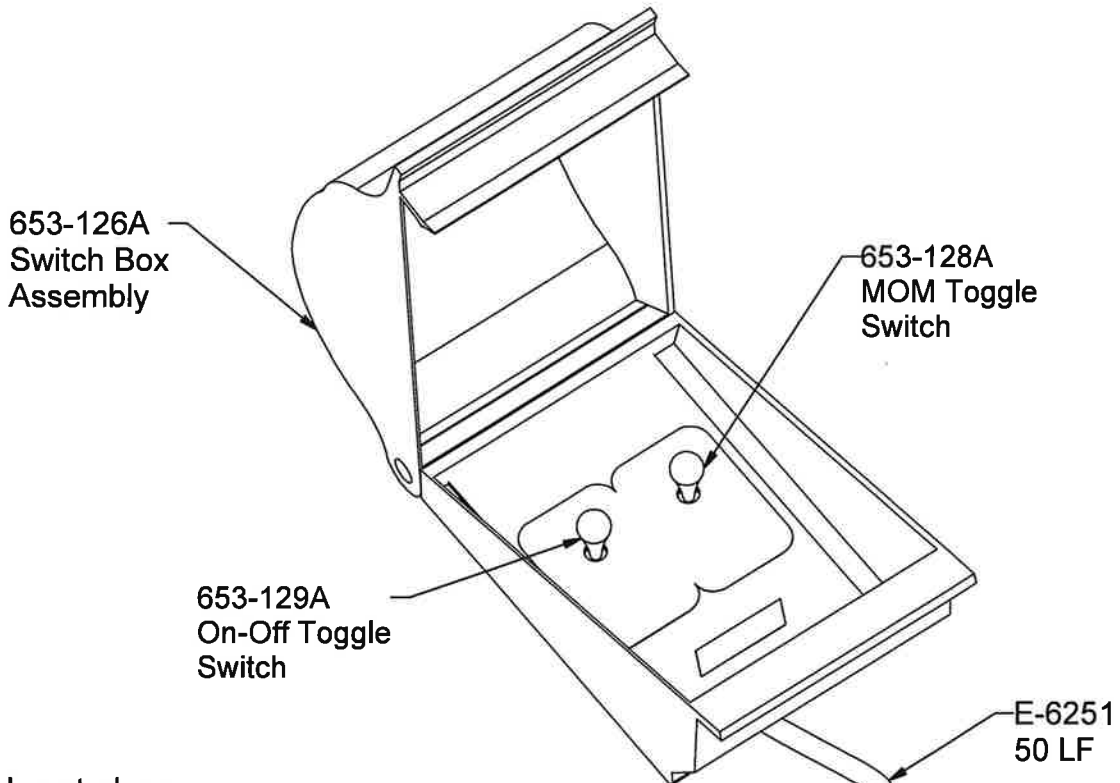

Located near
manhole. Use to
adjust spreader
pan speed and to
turn diverter on
and off.

